

# INSTALLATION AND SERVICE MANUAL

For Installation of Quantum 1,2,3 floodlights RGBW.  
Model. UQA-50004,UQA-50015 and UQA-50022

## PRODUCT DRAWING (DIMENSIONS)

SUITABLE FOR WET LOCATIONS

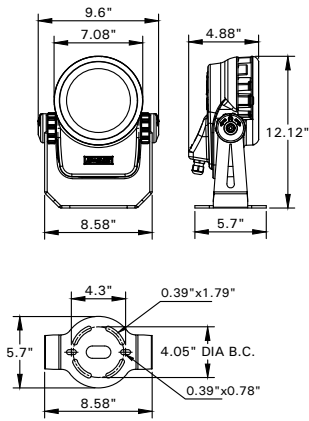

MOUNTING DETAIL  
UQA-50004

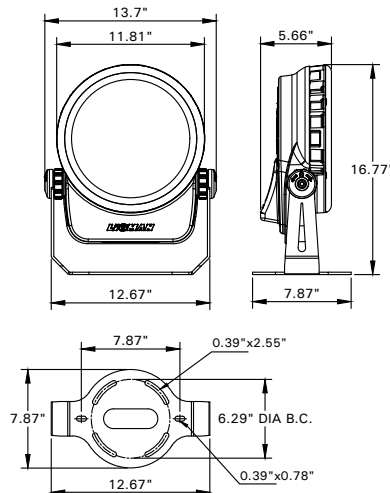

MOUNTING DETAIL  
UQA-50015

Max.mounting Height 7 m.

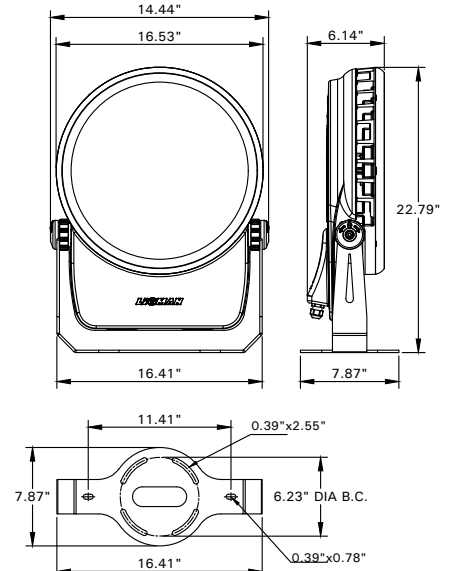

MOUNTING DETAIL  
UQA-50022

1

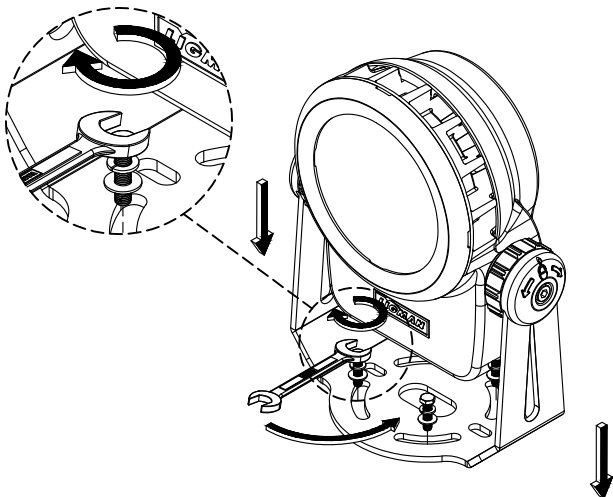

2

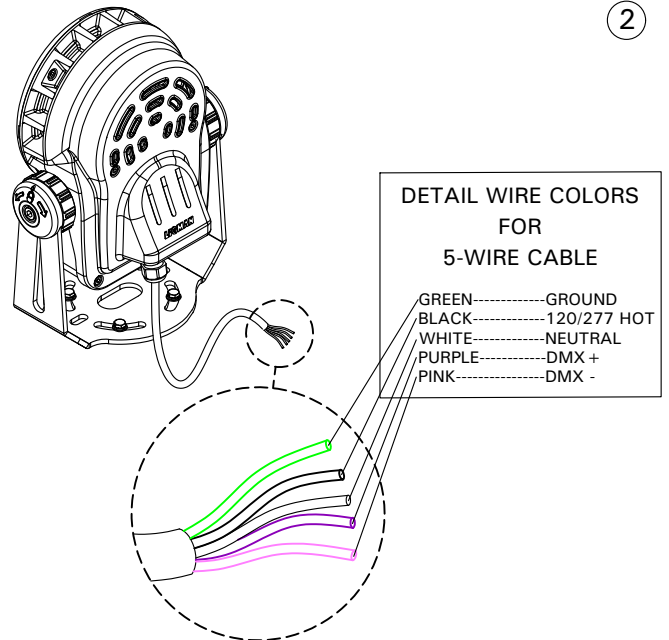

### Notice to installer :

**WIRING INSTRUCTIONS** Warning : RISK OF FIRE AND ELECTRICAL SHOCK. : FIXTURE MUST BE INSTALLED BY A QUALIFIED ELECTRICIAN ONLY>FIXTURE IS INTENDED FOR INSTALLATION IN ACCORDANCE WITH THE NATIONAL ELECTRICAL CODE, LOCAL AND FEDERAL CODE SPECIFICATIONS. DISCONNECT POWER BEFORE SERVICING.

**Ligman Lighting USA**

7144 NE Progress Court, Hillsboro  
Oregon, 97124, USA  
Tel : 503 645 0500 | Fax : 503 645 8100

